

The Story of West Harvard Gulch: Stream Restoration in an Urban Setting

A tale of a creek,
a railroad,
a cottonwood,
...and *bricks*

Presented by:
Barbara Chongtoua, Urban Drainage and Flood Control
District
Carolyn Roan, Muller Engineering Company



Physical



Chemical

Biological

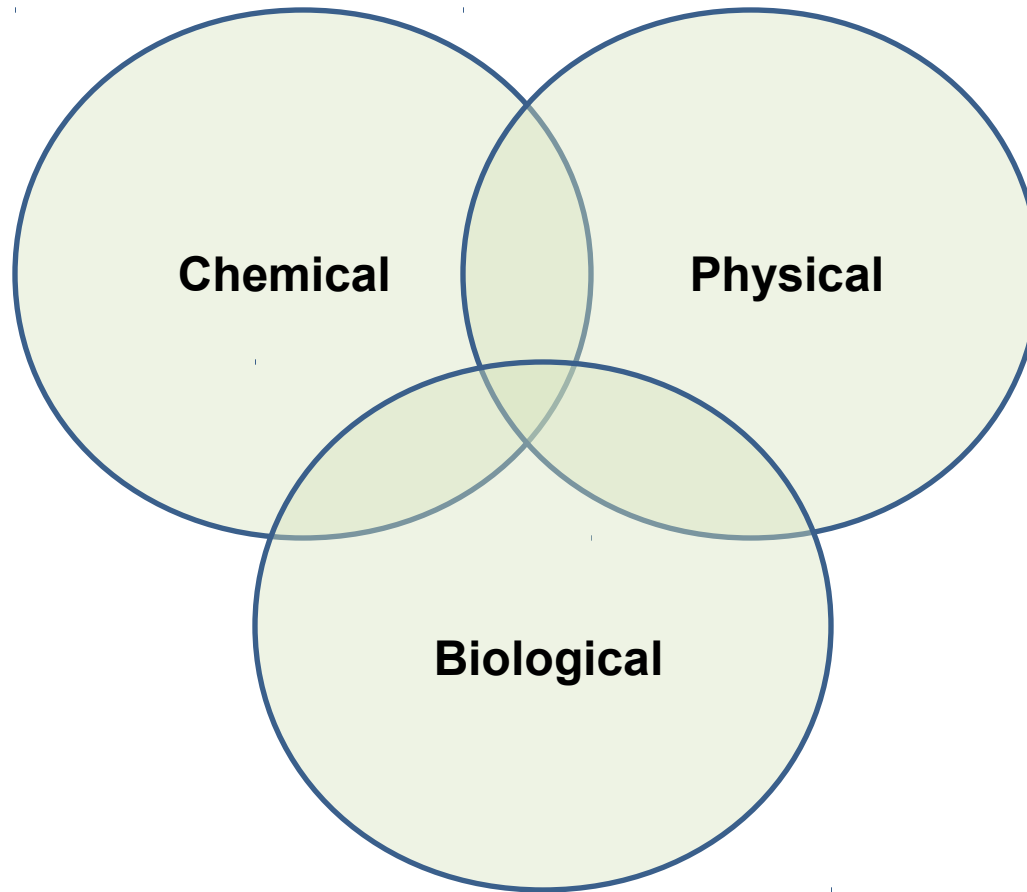

“...reestablishment of ecological processes, functions, and biotic/abiotic linkages, that lead to a persistent, resilient ecosystem that is integrated within its landscape.”—Society of Wetland Scientists



BNSF Railroad

**XCEL
Energy**

**General
Shale
(Robinson
Brick)**

S Platte River Dr

S Platte River Trail



Google earth

© 2012 Google

39°40'04.19" N 105°00'17.34" W elev 5276 ft

Imagery Date: 5/4/2011

Eye alt 6100 ft

• **SITE HISTORY**

•

•

•

•

•

•

•



2005 “Pre-Denver” vegetation identified by TRG (14 species of





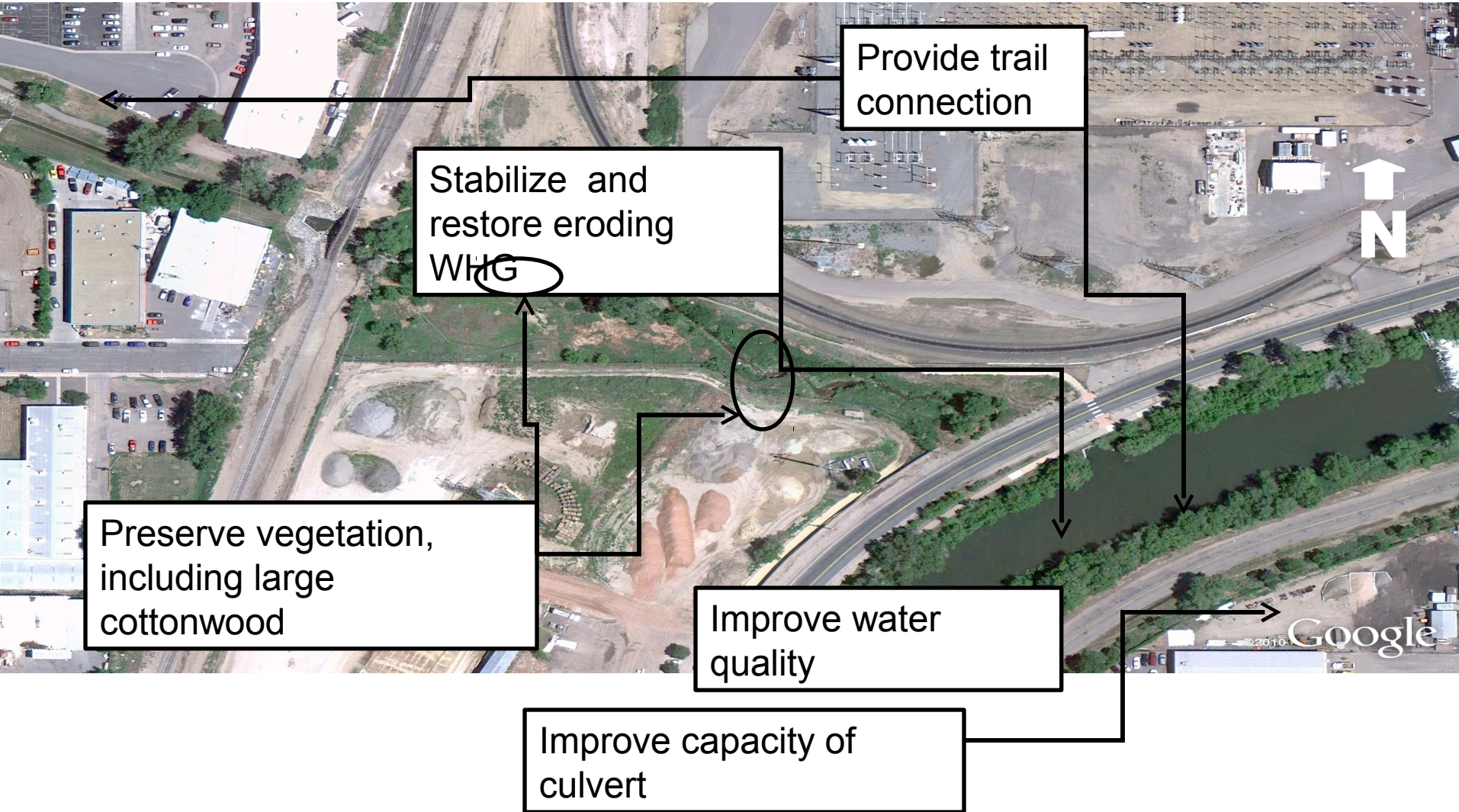
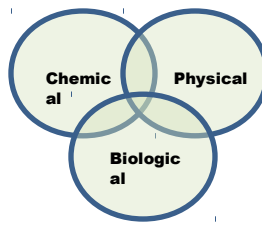

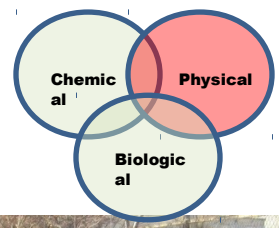

-
-
-
-
-



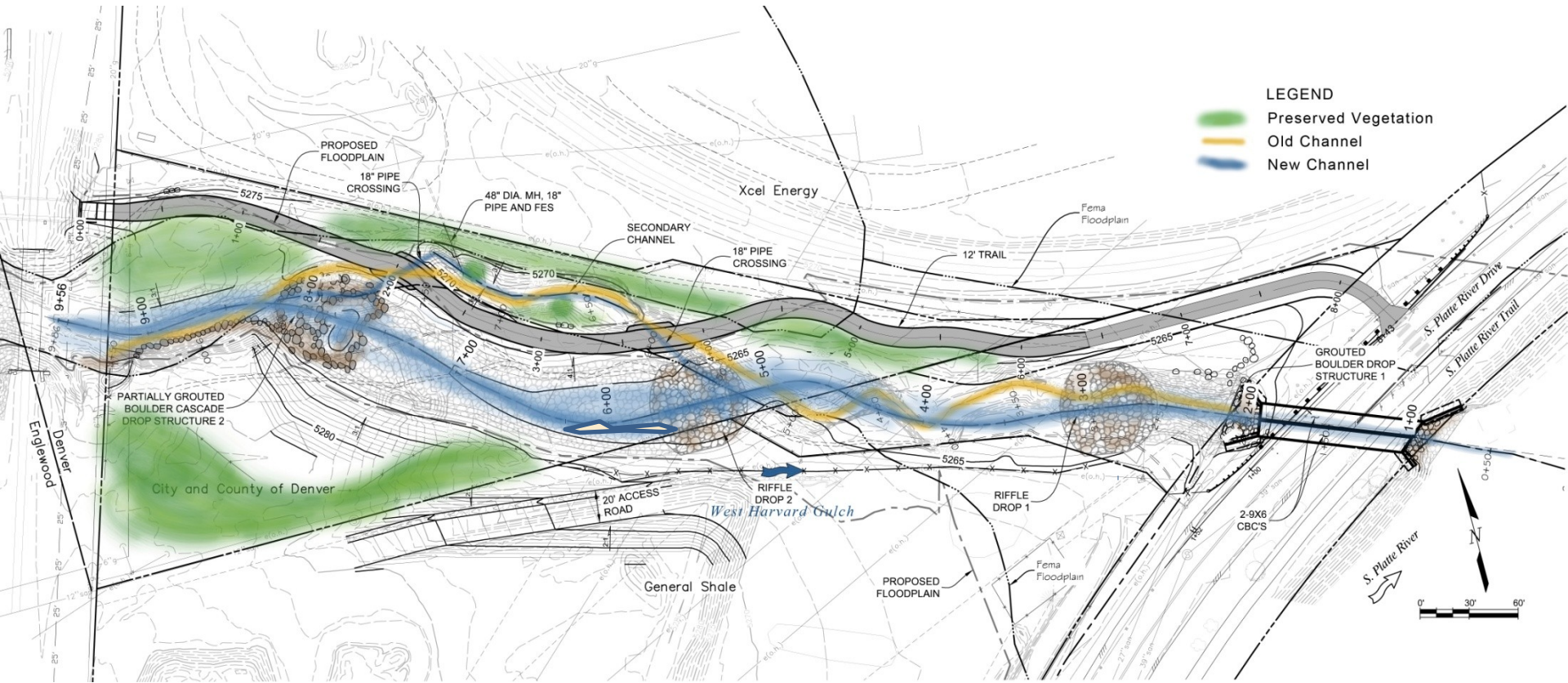

•

•

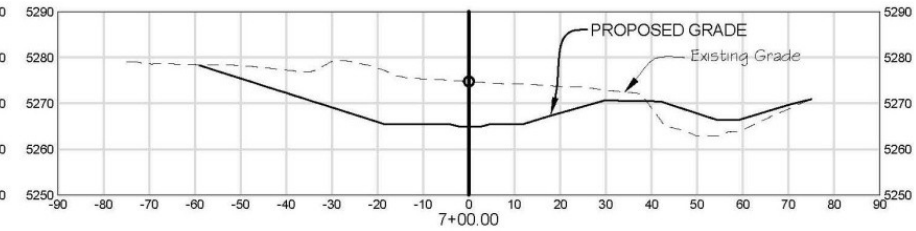
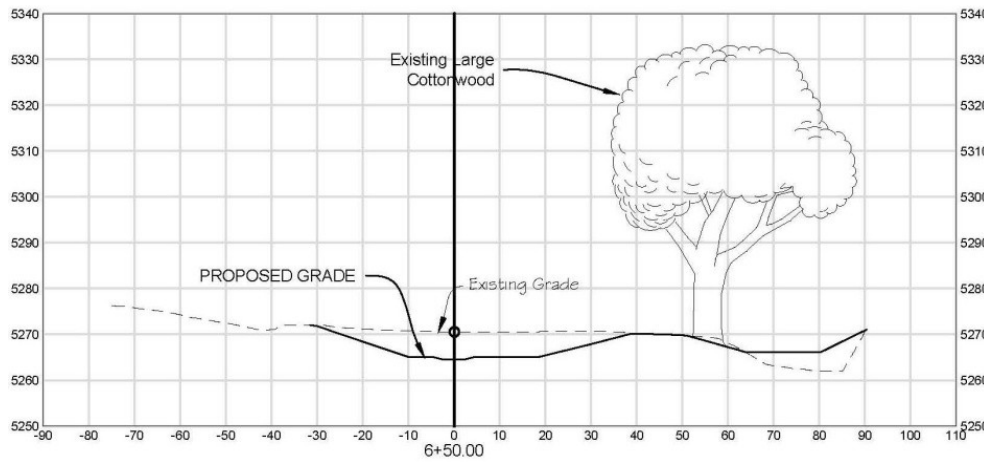
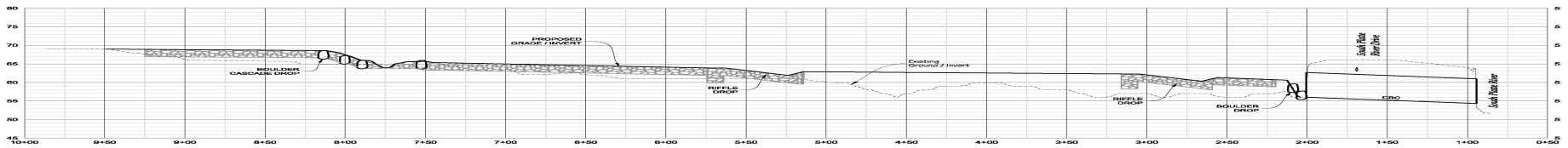
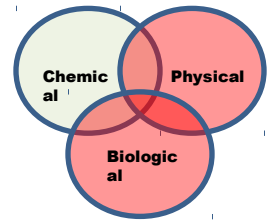

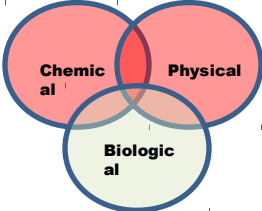
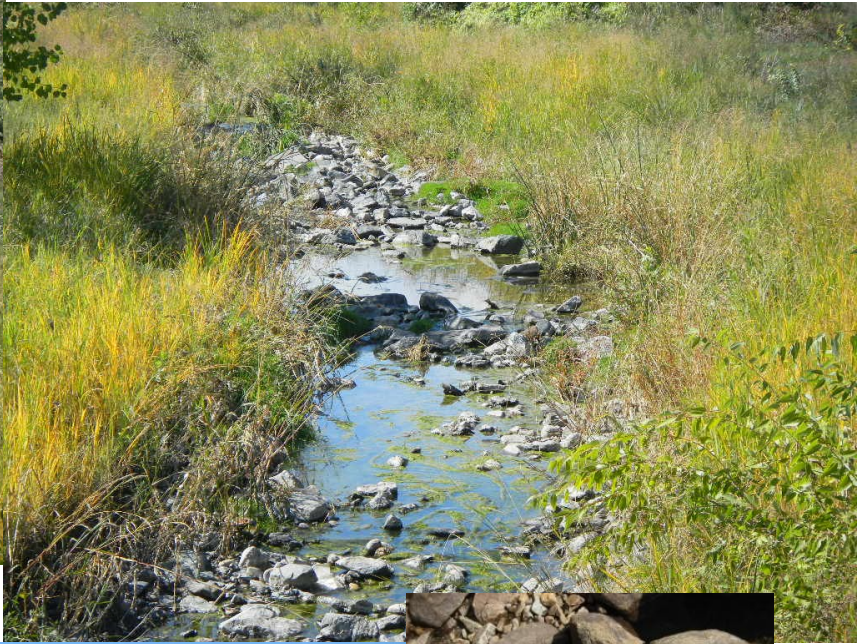



outlet Boulder Cascade Drop
What is it?





During construction,



After construction,
spring 2012



Today

Objective: improve C.M. water capacity



Before : 84-inch RCP



Before



After: 2-9'x6'

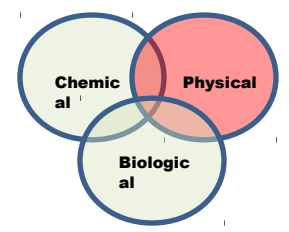

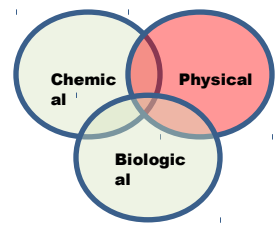

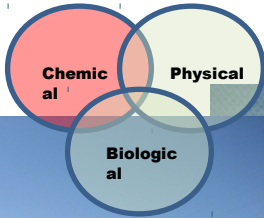

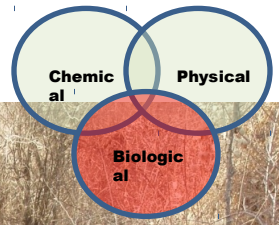

pre-

ings

)



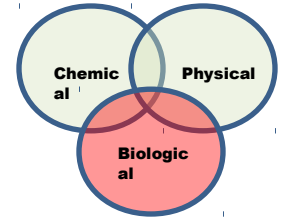

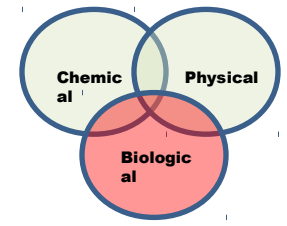



Before



After - end of construction



Today



Before



After



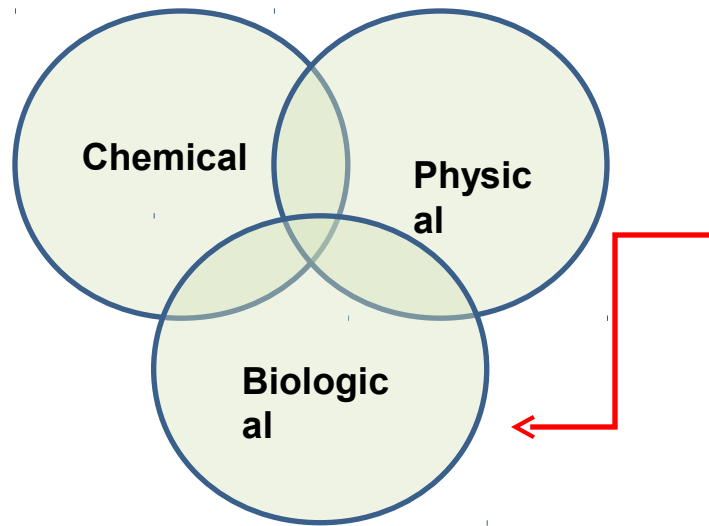
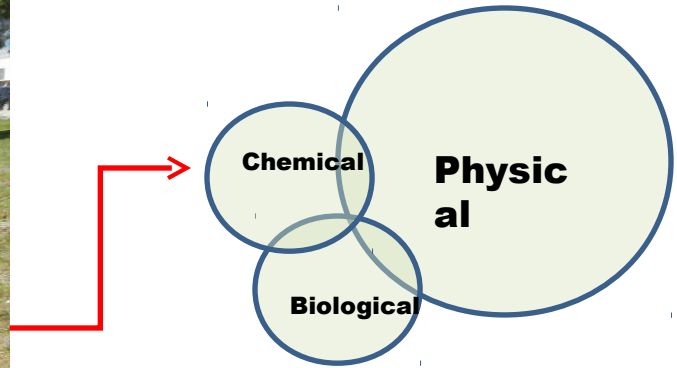

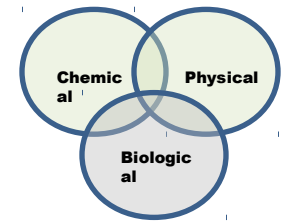

1. Give existing vegetation preeminence; preserve if possible

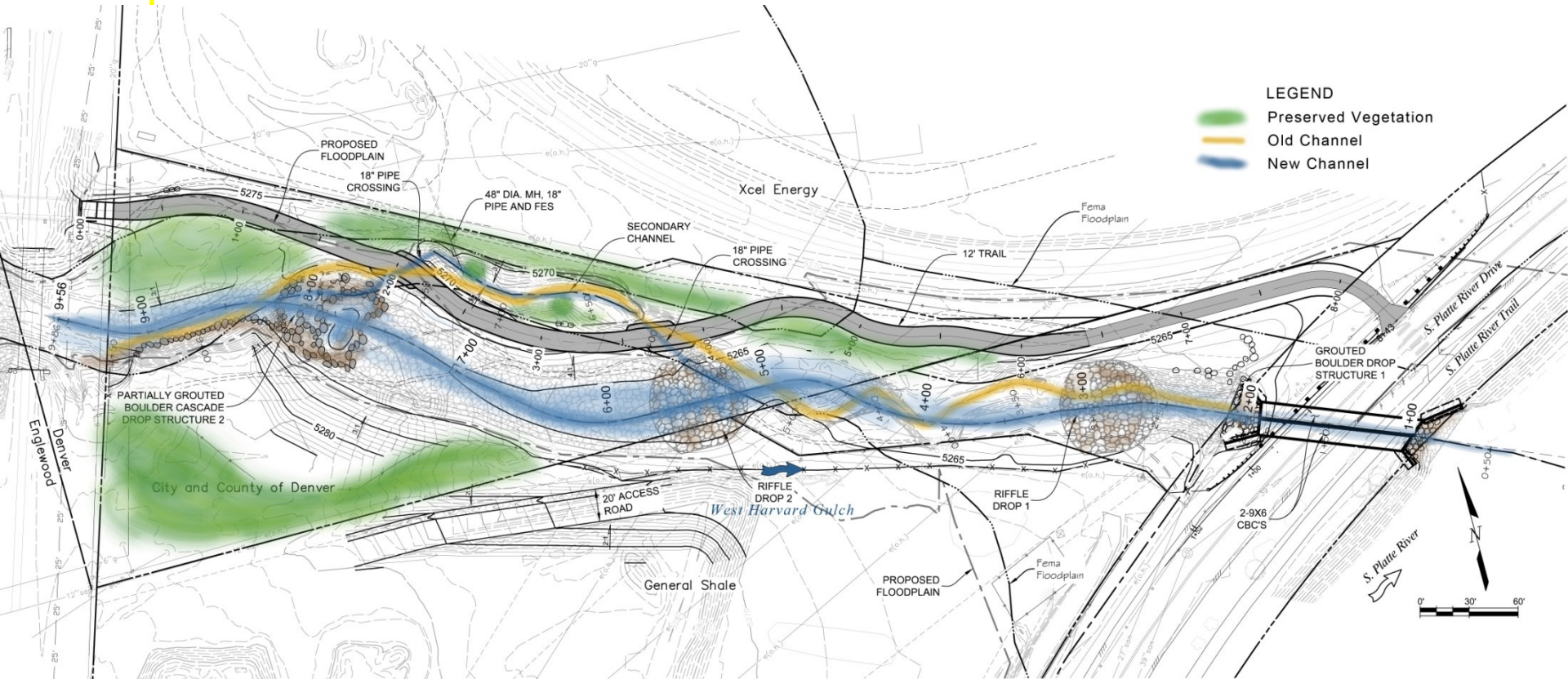

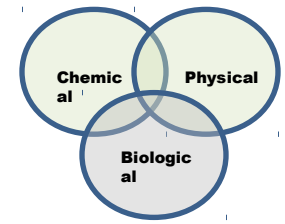

2. Create a flow of energy

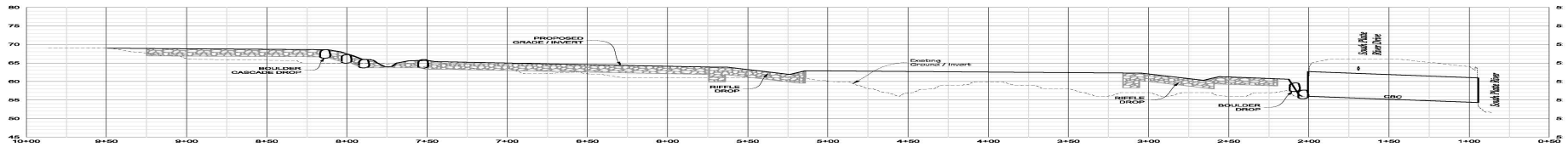

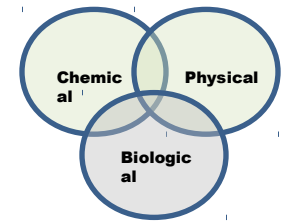

2.

3. Restore natural function



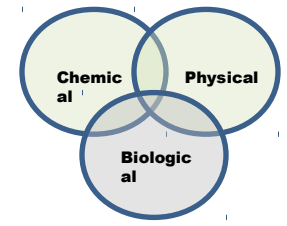

1.

2.

3.

4. Pursue every opportunity to enhance water quality.



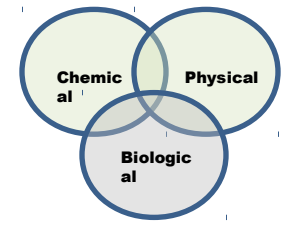

- Constraints
- What else.....?



